

CD-LX8/M

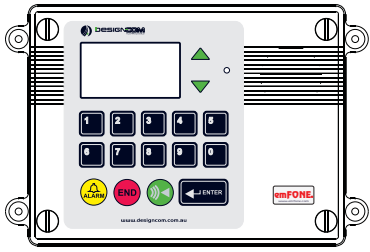

**Programming Help Number**  
 Programming the Help Number is done using the on screen commands  
**Default PIN : 123**

**Recording Voice Location Message**

To record a voice location message you must dial into the unit.  
 Enter the following sequence on your handset.  
 # 1 # 2 # 3 # 9 (record voice message) 0  
 Press \* 9 To hear back the recorded voice message

**Lift - 1**  
 Control Cabinet

Lift - 2  
 Control Cabinet

Lift - 3  
 Control Cabinet

Lift - 4  
 Control Cabinet

Lift - 5  
 Control Cabinet

Lift - 6  
 Control Cabinet

Lift - 7  
 Control Cabinet

**Lift - 8**  
 Control Cabinet

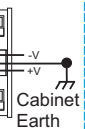
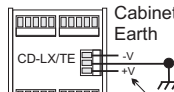

Note: Power can be connected directly to LX/M Board or one of the connected CD-LX/TE boards



Download the Complete Manual from the following address:  
<http://designcom.com.au/clientFiles/LX8ProductDoc.zip>

LX-8 intercom system  
 Installation wiring diagram

Rev: 1.0.0923.4  
 Sheet 1 of 2

Date: 2-05-09  
 Drawing Number: 0923LX8

**Programming Station Address:**

Programming the Station Address of the PIT, TOP & SPARE

- END Press and HOLD for 3 seconds (4 beeps)
- 7 8 5 1 ? END (2 beeps)  
 Lift number 1 - 8      Lift position
- END Press and HOLD for 3 seconds (3 beeps)
- 1 = TOP  
 3 = PIT  
 4 = SPARE      ← Lift position

**Programming CAR Station Address:**

Programming the station Address of the CAR

- ON/OFF Press and HOLD for 3 seconds (4 beeps)
- 7 8 5 1 ? 2 ON/OFF (2 beeps)  
 Lift number 1 or 2      Lift position 2 = CAR
- ON/OFF Press and HOLD for 3 seconds (3 beeps)



The Second PIT unit should be wired in parallel with the first PIT.  
 If this is not possible then wire back into the second Cabinet point

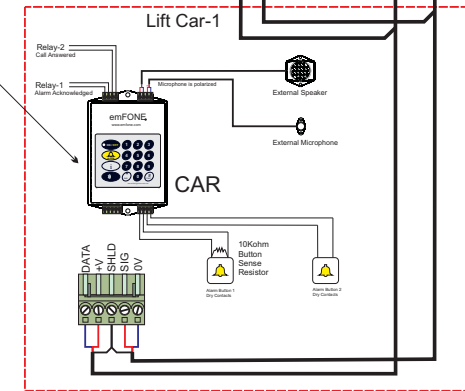
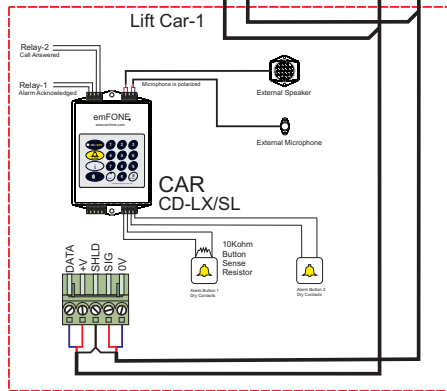

This DC cable can be extended to a location where there is a 120V to 240V AC socket.  
 Note: Power can be connected directly to CD-LX/M Board or one of the connected CD-LX/TE boards.

**Case Locking Keys**  
 1/4 Turn and pull all 4 keys  
 Anti-Clockwise to remove case

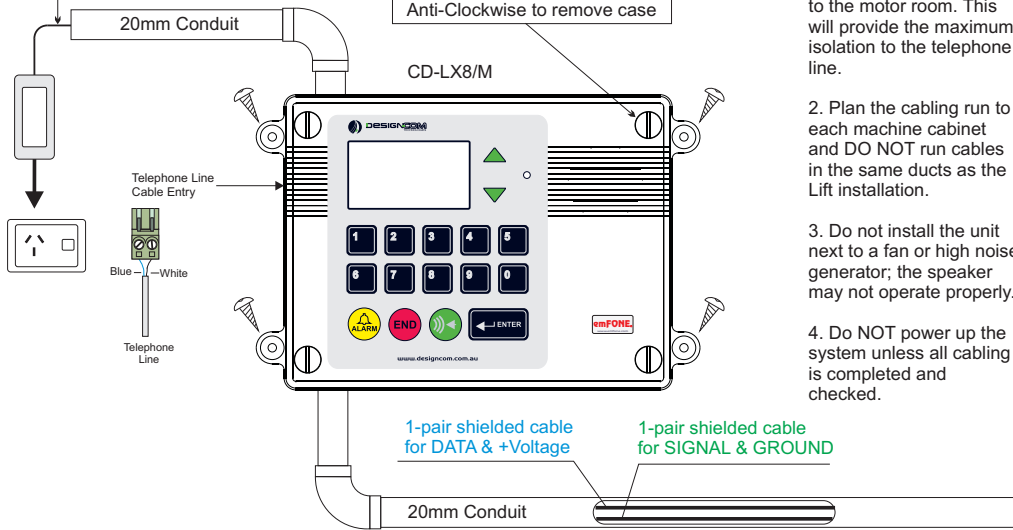

**Mounting Instructions;**

1. Mount the main system as close as possible to the telephone cable entry to the motor room. This will provide the maximum isolation to the telephone line.
2. Plan the cabling run to each machine cabinet and DO NOT run cables in the same ducts as the Lift installation.
3. Do not install the unit next to a fan or high noise generator; the speaker may not operate properly.
4. Do NOT power up the system unless all cabling is completed and checked.

**CAR**

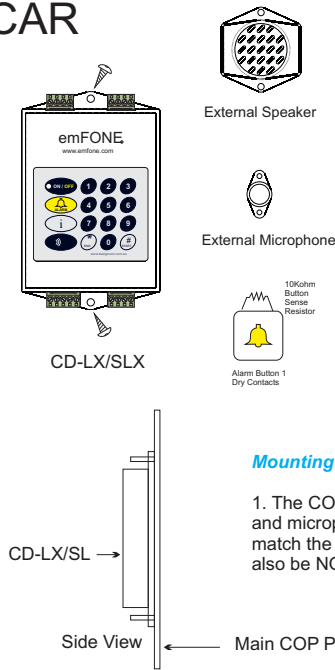

**Installing the Lift Station where external Speaker and Microphone is used;**

1. Mount the CD-LX/SLX module in a location where it is easily accessible.
2. The speaker and microphone must be mounted pointing into the lift car with an appropriate speaker grill and a minimum of a 2.5mm sized microphone hole.
3. The speaker and microphone wires are 3 meters long, DO NOT use alternatives.
4. Minimum distance between the microphone and speaker should be 120mm.
5. Install a 10K ohm resistor across the Alarm button.

**Mounting the Internal Speaker and Microphone module;**

1. The COP manufacturer MUST ensure that the mounting studs and the speaker and microphone grills are correctly engineered. If the microphone hole does not match the module then the unit may not operate at an acceptable level. There must also be NO air gap between the unit and the panel that is being installed.

**PIT**

Do NOT drill unnecessary holes in the product; it has been designed to meet Ip54 rating.

**Mounting Instructions;**

1. Remove the keyboard and the electronics from the main case.
2. Cut and drill the conduit entry point on bottom of the case, or cut the cable entry from the back of the case if the cables are coming from the wall.
3. Use 3 screws to mount the main case to the appropriate location in the PIT
4. Use small diameter cable between the circuit board and the terminating point. Make sure the cables in the terminating point are twisted together and fit screw caps.

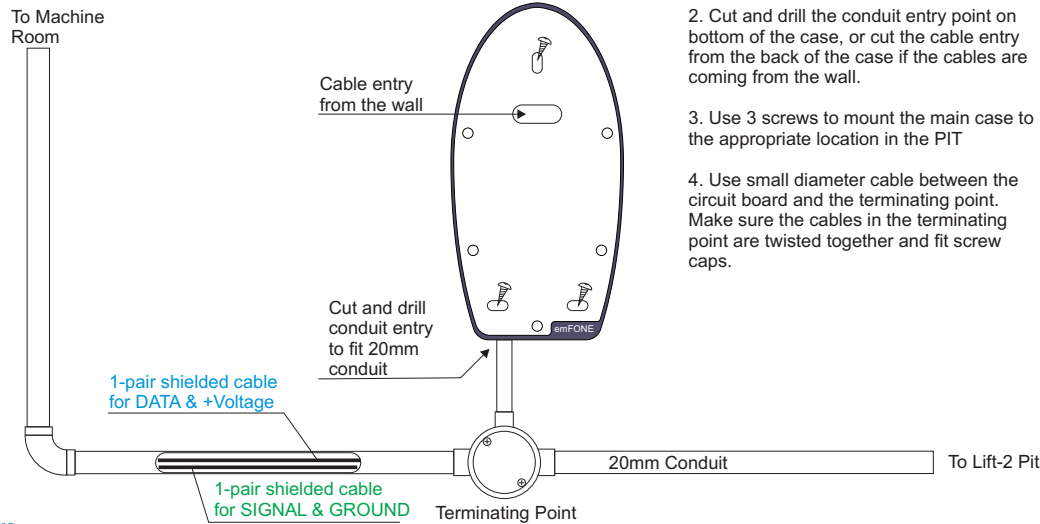

**TOP**

**Mounting Instructions;**

1. Follow the same instructions as per the PIT station.
2. Locate an appropriate location for the unit. Ideal suggestion will be as per the "X" markings on the diagram below.

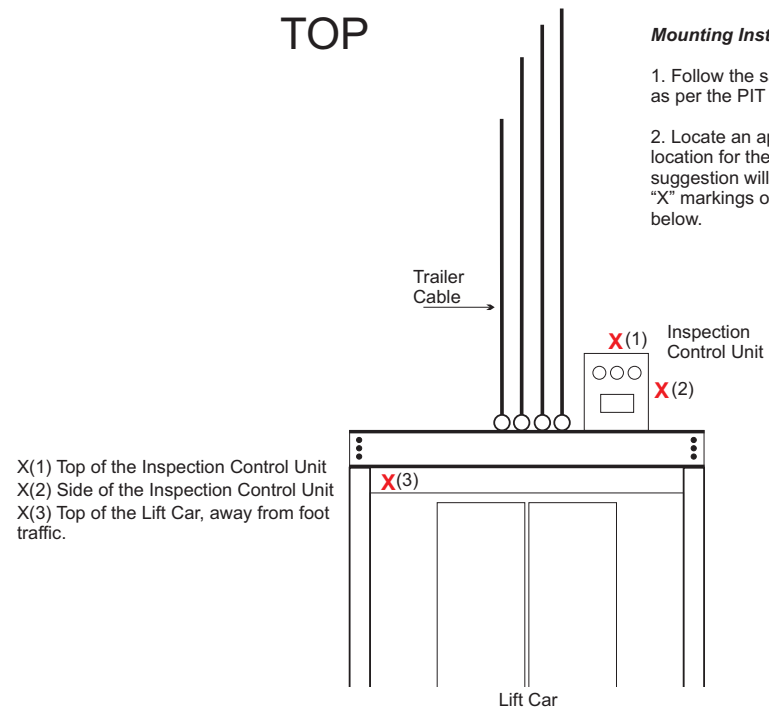

X(1) Top of the Inspection Control Unit  
 X(2) Side of the Inspection Control Unit  
 X(3) Top of the Lift Car, away from foot traffic.